

# FRESAMENTO

## FRESAMENTO MULTIFUNCIONAL



# AQX

Liga Leve • Ferro Fundido • Aço Carbono • Aço Liga • Aço Inoxidável • Aço Endurecido

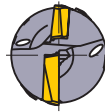

Número de Dentes : 4

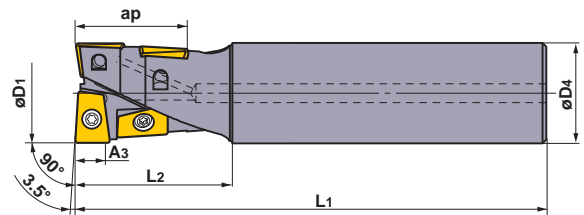

- A aresta de corte central do topo permite furação sem pré-furo.
- Com furos de refrigeração.

### TIPO ARESTA STANDARD

Somente ferramentas corte à direita.

Tipo	Referência para Pedido	Estoque	Furo de Refrig.	Dimensões (mm)					Parafuso de Fixação	Chave	Inserto	
				D1	L1	D4	L2	A3				ap
Standard	AQXR164SA16S	★	●	16	120	16	30	4.5	17.6	TS2A	①TKY06F	QOG/MT0830R-G1/M2
	164SN16S	★	●	16	120	16	30	4.5	17.6	TS2A	①TKY06F	
	174SA16S	★	●	17	120	16	30	4.5	17.6	TS2A	①TKY06F	
	174SN16S	★	●	17	120	16	30	4.5	17.6	TS2A	①TKY06F	
	204SA20S	★	●	20	130	20	35	6	22	TS25	①TKY08F	QOG/MT1035R-G1/M2
	204SN20S	★	●	20	130	20	35	6	22	TS25	①TKY08F	
	214SA20S	★	●	21	130	20	35	6	22	TS25	①TKY08F	
	214SN20S	★	●	21	130	20	35	6	22	TS25	①TKY08F	
	254SA25S	★	●	25	140	25	40	7.5	27.5	TS33	②TKY08D	QOG/MT1342R-G1/M2
	254SN25S	★	●	25	140	25	40	7.5	27.5	TS33	②TKY08D	
	264SA25S	★	●	26	140	25	40	7.5	27.5	TS33	②TKY08D	
	264SN25S	★	●	26	140	25	40	7.5	27.5	TS33	②TKY08D	
	324SA32S	★	●	32	150	32	50	9.5	35.2	TS407	②TKY15D	QOG/MT1651R-G1/M2
	324SN32S	★	●	32	150	32	50	9.5	35.2	TS407	②TKY15D	
	334SA32S	★	●	33	150	32	50	9.5	35.2	TS407	②TKY15D	
	334SN32S	★	●	33	150	32	50	9.5	35.2	TS407	②TKY15D	
354SA32S	★	●	35	150	32	50	11	40	TS407	②TKY15D	QOG/MT1856R-G1/M2	
354SN32S	★	●	35	150	32	50	11	40	TS407	②TKY15D		
404SA32S	★	●	40	160	32	60	12	44	TS55	②TKY25D	QOG/MT2062R-G1/M2	
404SN32S	★	●	40	160	32	60	12	44	TS55	②TKY25D		
504SA42S	★	●	50	170	42	70	15	55	TS6S	③TKY30T	QOG/MT2576R-G1/M2	
504SN42S	★	●	50	170	42	70	15	55	TS6S	③TKY30T		
Longa	AQXR164SA16L	★	●	16	175	16	50	4.5	17.6	TS2A	①TKY06F	QOG/MT0830R-G1/M2
	164SN16L	★	●	16	175	16	50	4.5	17.6	TS2A	①TKY06F	
	174SA16L	★	●	17	175	16	30	4.5	17.6	TS2A	①TKY06F	
	174SN16L	★	●	17	175	16	30	4.5	17.6	TS2A	①TKY06F	
	204SA20L	★	●	20	185	20	60	6	22	TS25	①TKY08F	QOG/MT1035R-G1/M2
	204SN20L	★	●	20	185	20	60	6	22	TS25	①TKY08F	
	214SA20L	★	●	21	185	20	35	6	22	TS25	①TKY08F	
	214SN20L	★	●	21	185	20	35	6	22	TS25	①TKY08F	
	254SA25L	★	●	25	220	25	75	7.5	27.5	TS33	②TKY08D	QOG/MT1342R-G1/M2
	254SN25L	★	●	25	220	25	75	7.5	27.5	TS33	②TKY08D	
	264SA25L	★	●	26	220	25	40	7.5	27.5	TS33	②TKY08D	
	264SN25L	★	●	26	220	25	40	7.5	27.5	TS33	②TKY08D	
	324SA32L	★	●	32	230	32	90	9.5	35.2	TS407	②TKY15D	QOG/MT1651R-G1/M2
	324SN32L	★	●	32	230	32	90	9.5	35.2	TS407	②TKY15D	
	334SA32L	★	●	33	230	32	50	9.5	35.2	TS407	②TKY15D	
	334SN32L	★	●	33	230	32	50	9.5	35.2	TS407	②TKY15D	
	354SA32L	●	●	35	230	32	50	11	40	TS407	②TKY15D	QOG/MT1856R-G1/M2
	354SN32L	●	●	35	230	32	50	11	40	TS407	②TKY15D	
	404SA32L	★	●	40	240	32	60	12	44	TS55	②TKY25D	QOG/MT2062R-G1/M2
	404SN32L	★	●	40	240	32	60	12	44	TS55	②TKY25D	
504SA42L	★	●	50	250	42	70	15	55	TS6S	③TKY30T	QOG/MT2576R-G1/M2	
504SN42L	★	●	50	250	42	70	15	55	TS6S	③TKY30T		

\*1 Dimensão A3 representa a profundidade de corte quando a aresta de corte consiste de 2 inserts. \*\*2 ap : Máxima profundidade de corte. \*3 Torque de Fixação (N • m) ●●●TS2A=0.6, TS25=1.0, TS33=1.0, TS407=3.5, TS55=7.5, TS6S=10.0

● : Estoque mantido no Japão. ★ : Estoque mantido.