



# 1/8 HP. Under Water Coolant Pump



**VERTEX**<sup>®</sup>

## Features

This is the pump in best quality with anti-rust treatment, use high grade material for the complete set and has been duly inspected in five steps by precision electron device.

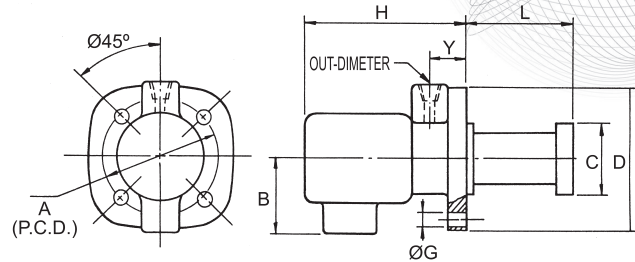
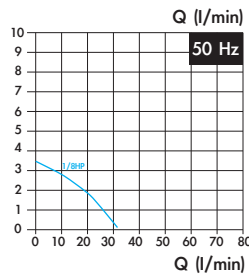

Unit:mm

POWER	A	B	C	D	G	H	Y	OUT-DIMETER
1/8 HP	128±0.2	105	Ø90	Ø150	Ø8	160	19	PT 3/8

ORDER NO.	TYPE	POWER	L m/m	PUMPING WATER		WEIGHT (kg)	CODE NO.
				1 m/min	2 m/min		
VWP-0810	UNDER WATER	1/8 HP	100	27ℓ-28ℓ	25ℓ-26ℓ	5.5	1026-001
VWP-0813			130				
VWP-0815			150				
VWP-0818			180				



# 1/4 HP. Under Water Coolant Pump

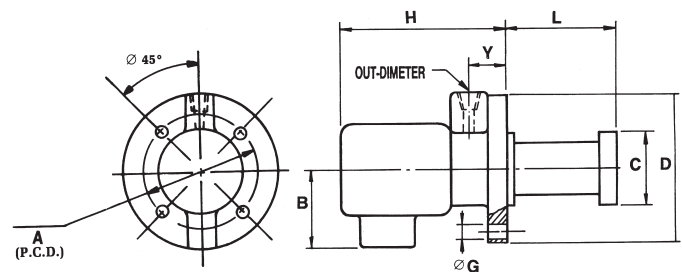
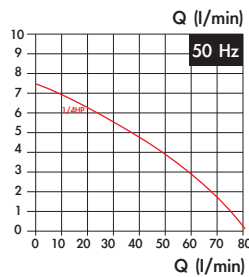

Unit:mm

POWER	A	B	C	D	G	H	Y	OUT-DIMETER
1/4 HP	158±0.2	125	Ø122	Ø180	Ø8	180	26	PT 1/2

ORDER NO.	TYPE	POWER	L m/m	PUMPING WATER		WEIGHT (kg)	CODE NO.
				1 m/min	2 m/min		
VWP-0415	UNDER WATER	1/4 HP	160	74ℓ-76ℓ	71ℓ-72ℓ	11.1	1026-010
VWP-0418			180				
VWP-0420			200				
VWP-0424			240				
VWP-0427			270				



# Self Priming Coolant Pump 1/8 HP. 1/4 HP

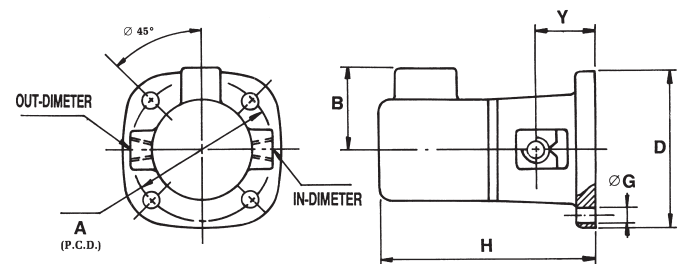
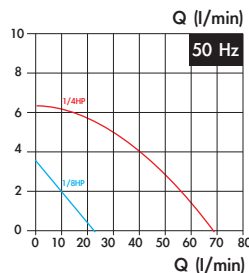

Unit:mm

POWER	A	B	D	G	H	Y	IN-DIMETER	OUT-DIMETER
1/8 HP	140±0.2	105	165	Ø8	195	50±0.5	PT 3/8	PT 3/8
1/4 HP	185±0.2	125	225	Ø8	240	65±0.5	PT 1/2	PT 1/2

ORDER NO.	TYPE	POWER	PUMPING WATER		WEIGHT (kg)	CODE NO.
			1 m/min	2 m/min		
VWP-089	SELF PRIMING	1/8 HP	26ℓ-27ℓ	24ℓ-25ℓ	5.9	1026-020
VWP-049		1/4 HP	73ℓ-75ℓ	70ℓ-71ℓ		