



# Taper Shank For Boring Heads Series BST, VBK



# VERTEX®

## Modular Boring Systems

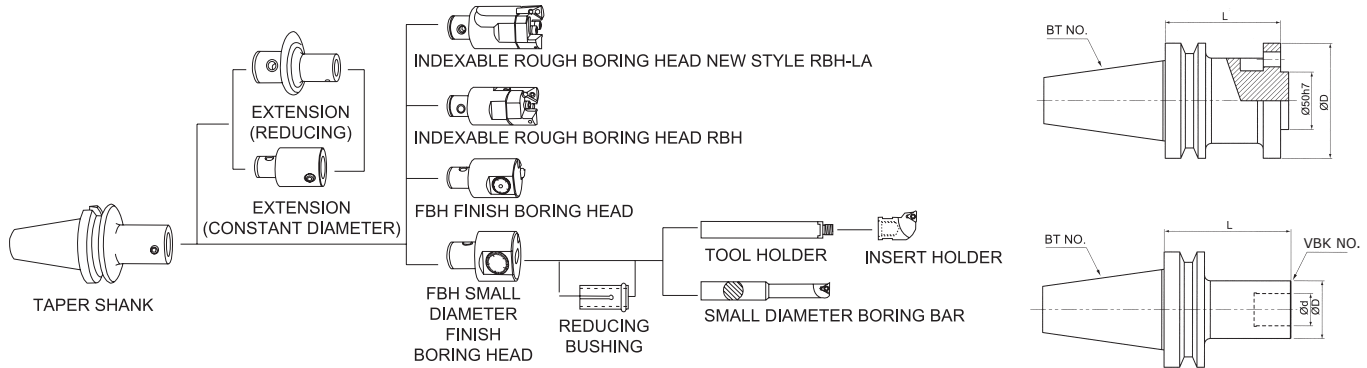

## Extension (Reduced)

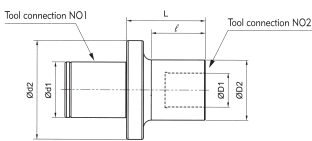

ORDER NO.	d1	d2	D1	D2	L	ℓ	Applicable Boring Heads	Weight (kg)	CODE NO.
VBK2-1-36L	14	24	11	19	36	30	FBH20	0.1	3320-301
VBK3-1-41L	18	31			41	30	FBH20	0.15	3320-302
VBK3-2-37L			14	24	37	25	RBH25 ; FBH25	0.15	3320-303
VBK4-1-58L	22	39	11	19	58	40	FBH20	0.3	3320-304
VBK4-2-50L			14	24	50	36	RBH25 ; FBH25	0.3	3320-305
VBK4-3-50L			18	31	50	37	RBH32 ; FBH32	0.35	3320-306
VBK5-1-60L	28	50	11	19	60	40	FBH20	0.45	3320-307
VBK5-2-54L			14	24	54	35	RBH25 ; FBH25	0.45	3320-308
VBK5-2-74L					74	55	RBH25 ; FBH25	0.5	3320-309
VBK5-3-47L			18	31	47	29	RBH32 ; FBH32	0.5	3320-310
VBK5-3-72L					72	54	RBH32 ; FBH32	0.6	3320-311
VBK5-4-42L			22	39	42	25	RBH40 ; FBH40	0.5	3320-312
VBK5-4-67L	67	50			RBH40 ; FBH40	0.7	3320-313		
VBK6-1-70L	36	64	11	19	70	40	FBH20	0.9	3320-314
VBK6-2-63L			14	24	63	45	RBH25 ; FBH25	0.7	3320-315
VBK6-2-93L					93	75	RBH25 ; FBH25	0.8	3320-316
VBK6-3-56L			18	31	56	39	RBH32 ; FBH32	0.75	3320-317
VBK6-3-96L					96	79	RBH32 ; FBH32	0.95	3320-318
VBK6-4-51L					22	39	51	35	RBH40 ; FBH40
VBK6-4-101L			101	85			RBH40 ; FBH40	1.3	3320-320
VBK6-5-41L			28	52	41	25	RBH52 ; FBH52	0.85	3320-321
VBK6-5-91L					91	75	RBH52 ; FBH52	1.45	3320-322



## Extension (Constant Diameter)

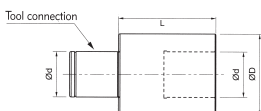

ORDER NO.	d	D	L	Applicable Boring Heads	Weight (kg)	CODE NO.
VBK1-1-30L	11	19	30	FBH20	0.07	3320-323
VBK2-2-30L	14	24	30	RBH25 ; FBH25	0.1	3320-324
VBK3-3-30L	18	31	30	RBH32 ; FBH32	0.15	3320-325
VBK4-4-45L	22	39	45	RBH40 ; FBH40 ; CBI4	0.4	3320-326
VBK5-5-60L	28	50	60	RBH52 ; FBH52 ; CBI5	0.8	3320-327
VBK6-6-60L	36	64	60	RBH68/RBH90 ; FBH68, 100, 150 ; CBI6	1.4	3320-328